

DONT'S

- Smoking and open fire are strictly prohibited on the entire site. Smoking is only permitted in the specially designated areas.
- Eating and drinking in the workplace outside, in laboratories and installations is prohibited.
- Film/Photography is not allowed without a valid permit.
- Entering the installations without the permission of the shift supervisor is prohibited.
- Wearing rings is prohibited in the production environment of Nouryon.

PPE zoning on the site

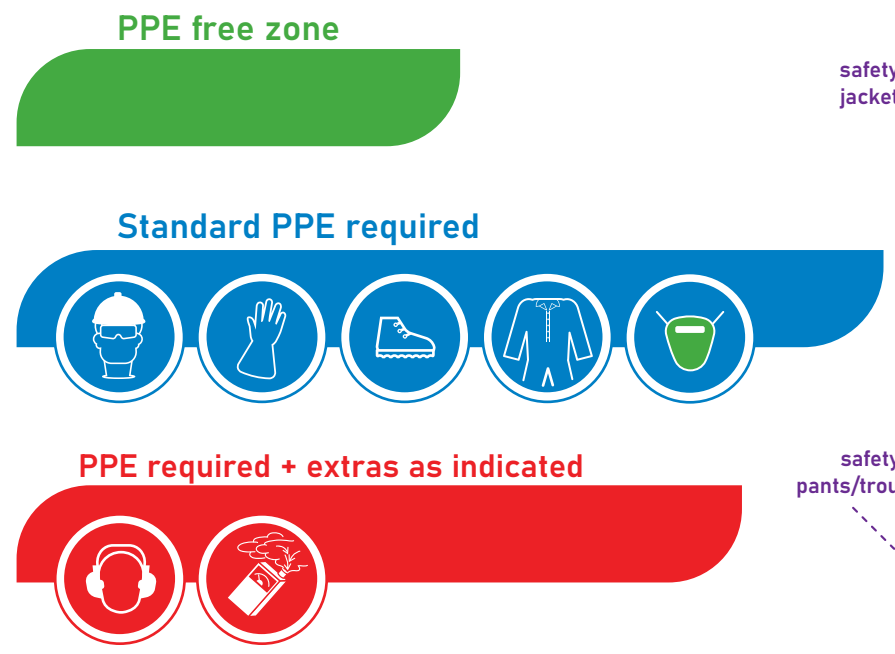

PPE STANDARD



In case of emergency

Alert the control room immediately or call:



Internal: 2222
Via mobile: 010-438 9888

In case of emergency and / or accident report:

- Who you are
- What happened
- Where it happened

What to do when the alarm goes off

- Stop all work, switch off equipment and ventilation systems.
- Close windows and doors (not locked).
- Leave the workplace in cross wind direction to the nearest assembly point (Safety Area).

Test alarm: Every Monday at 12:00

DO'S

- Cleanliness, order and hygiene (good housekeeping).
- Always hold the handrail when using stairs.
- The national road traffic regulations apply to the site area. The maximum speed is 20 km/h.
- Visitors are always accompanied.



Life Saving Rules

Stop working when you see unsafe conditions or behavior.

- Work with a valid work permit when required.
- Make sure moving machinery is guarded.
- Wear a seatbelt in motor vehicles when provided.
- Use fall protection when working at height.
- Check equipment is isolated before work begins.
- Do not use alcohol or drugs at work.
- Obtain a permit for entry into a confined space.
- Obtain authorization before disabling safety equipment.

If you break one of these "Life Saving Rules", a life-threatening situation can arise. Therefore, appropriate sanctions will follow in case of any violations.



Welcome to Bedrijvenpark Botlek

This handout contains critical safety-related information for all persons visiting our site. Please take the time to read it carefully. We value everyone's safety, therefore we need your support in making sure everyone works safely and nobody gets hurt. Nouryon, Nobian, Air Products, Shin-Etsu and SGS are located in this park.

Wear the access pass visible!



First aid and accidents

Any injury must be treated by a first-aider or at the medical post. Any accident should be reported to the shift supervisor.

Always make sure that you are aware of hazards and procedures **before** starting work.



Emergency showers and eye wash bottles are available at various locations in the factories/plant. Get informed about these facilities before starting work.

Avoid any contact with hazardous substances!

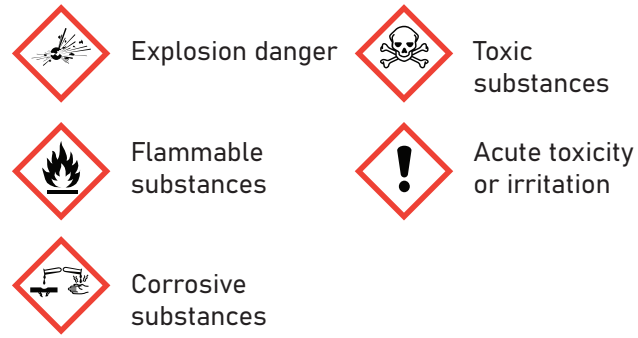

EX Potentially explosive areas are marked with yellow-black markings and this sign.



Immediately report use of a fire extinguisher to the shift supervisor.

In case of gas alarm

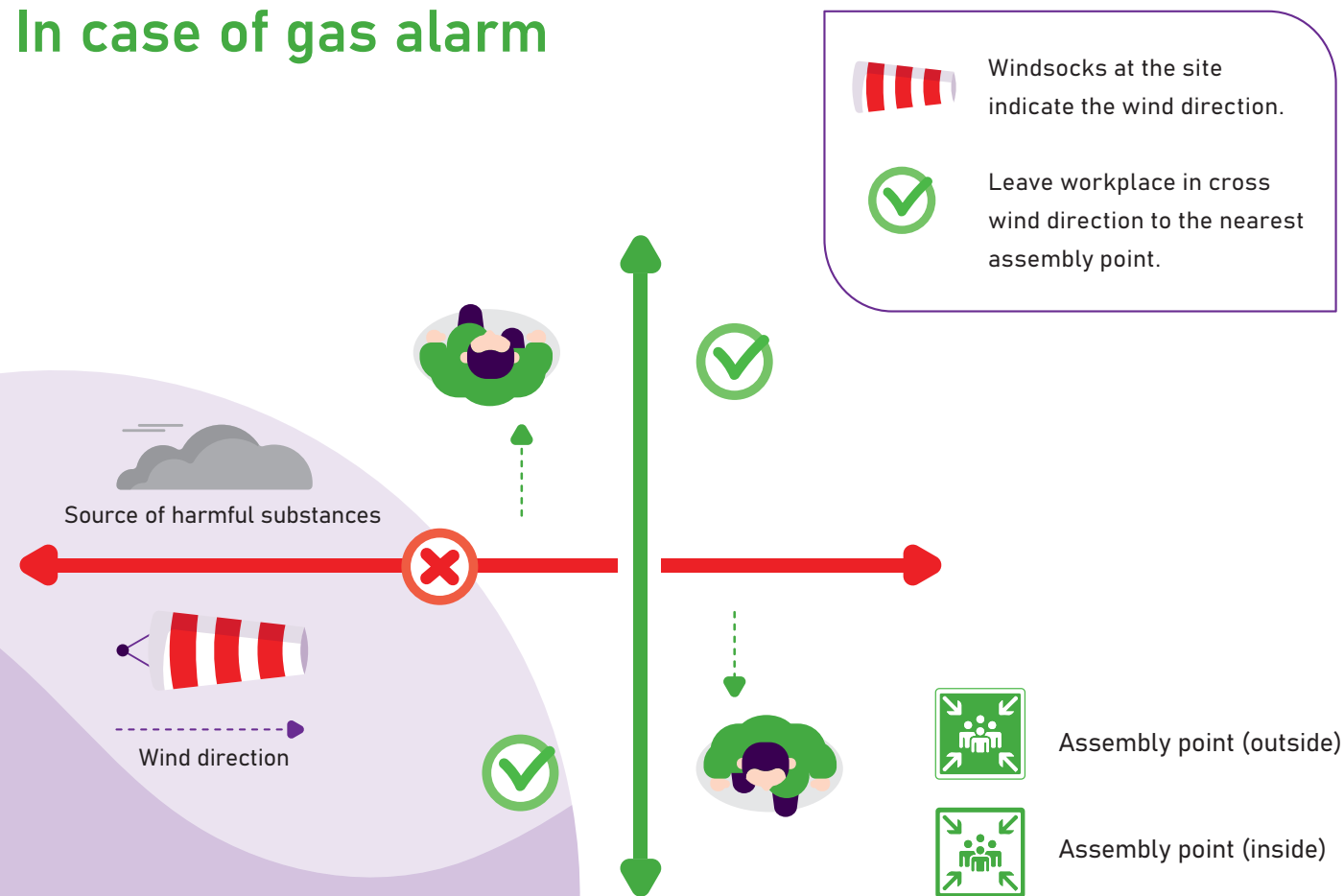

Map

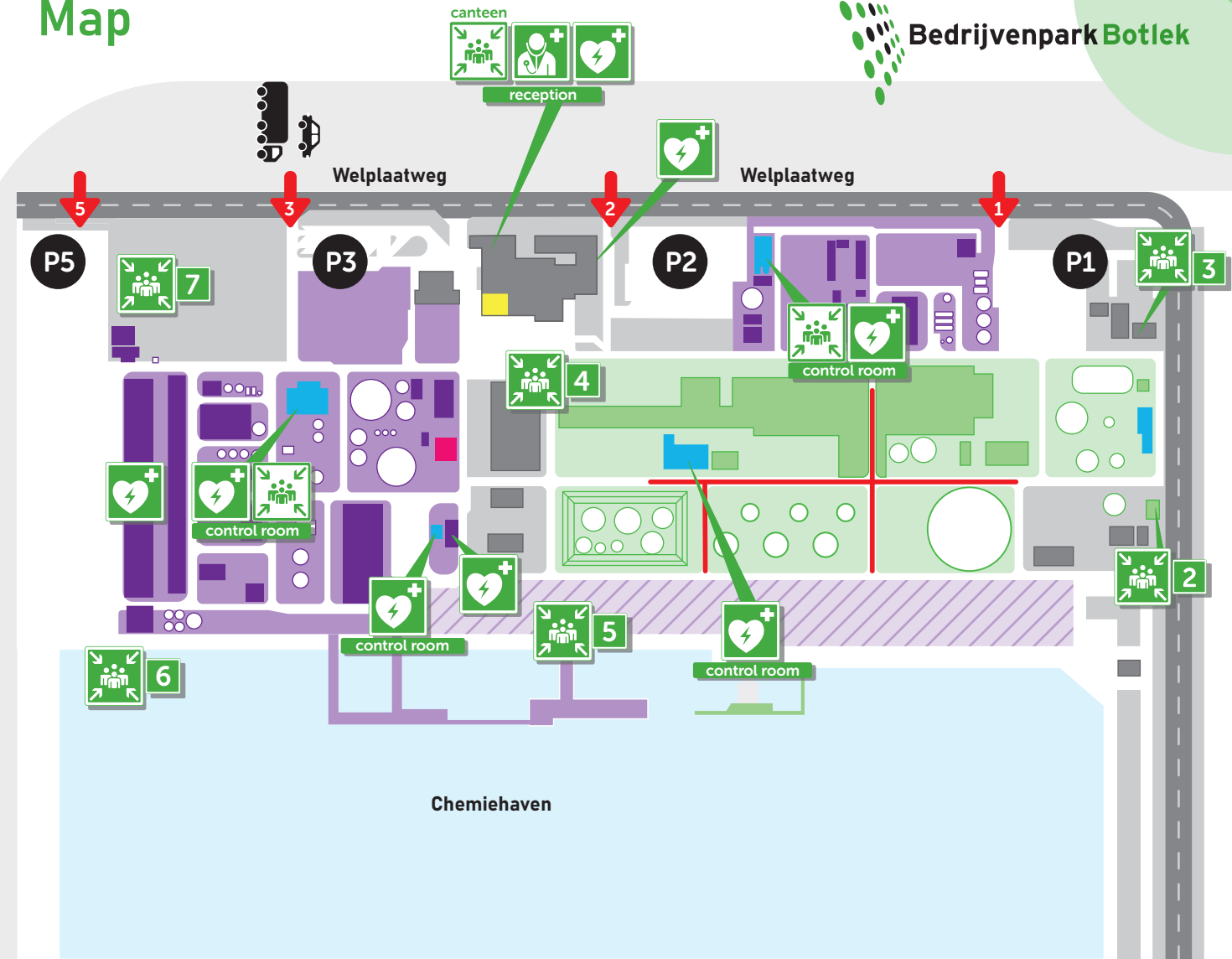

Bedrijvenpark Botlek

- Nobian CCU
- Nouryon MAE
- Shin-Etsu
- SGS
- Air Products
- Office & Facilities
- Control room
- Parking
- AED (defibrillator)
- Medical post
- Assembly point (outside)
- Assembly point (inside)
- Entrances
- Prohibited motorized traffic